



广东耀达房屋科技股份有限公司

地址: 广东省佛山市南海区丹灶镇桂丹西路58号

业务热线: +86-13929956668

电话: +86-757-85407788

传真: +86-757-85407733

邮箱: info@yaodaprefab.com

Http://www.fsyada.com



(WeChat)

GUANGDONG YAODA HOUSE TECHNOLOGY CO.,LTD

Add: No.58,GuiDan Xi Road,Danzao Town,
NanHai zone,Foshan City Guangdong Province China

Mob : +86-13827749833

Tel : +86-757-82706933

Fax : +86-757-82700609

E-mail : exportmanager@yaodaprefab.com

Http://www.chinaprefabhouse.com



(Web Site)



耀达房屋科技

YAODA HOUSE TECHNOLOGY



集成建筑
Integrated Building



模块建筑
Module Construction



组合集装箱
Container House



轻钢别墅
Villa



钢结构
Steel Structure



活动房屋
Prefab House

广东耀达房屋科技股份有限公司

GUANGDONG YAODA HOUSE TECHNOLOGY CO., LTD

中国 · 佛山

YAODA HOUSE TECHNOLOGY
FOCUS ON CHINA PREFABRICATED HOUSE **INNOVATION** & **CREATION**

耀达房屋科技
致力于中国活动房屋的**改革**和**创新**

C [公司简介] Company profile

广东耀达房屋科技股份有限公司位于经济发达的佛山市，凭借人杰地灵的优势，把握经济发民的良好时机，二十多年来秉承“信誉为本、质量为先、顾客为上、开拓创新”的经营宗旨，和“思利及人”的营销理念赢得国内外客户的赞赏，发展至今已成为中国活动板房行业的领航企业和中国活动板房最具影响力品牌。

耀达房屋科技专为各施工单位设计生产全新概念环保经济型活动房屋，能做到安装快捷、起货准时、运输储存方便。其产品具有防火、防腐、隔音、隔热、防7级台风，既环保美观，又可以多次重复周转使用的定型产品。耀达活动板房实现临建房屋标准通用，高效的建筑理念，它是以标准模数进行长、宽、高组合和采用螺栓连接的新型房屋产品。

我们公司有50,000平方米的生产、研发经营面积，拥有二十多项以上国家专利和十多年的外贸管理经验。并拥有一支15年以上经验的安装队伍，可以为您提供设计、安装、培训等服务，排除您售后的担忧。基于我们高质量的产品和完善的售后服务，先后成功与广州国际机场、广州大学城、香港迪斯尼、广东火电集团、中国四川救灾板房项目、印尼政府震后援建项目等合作。产品基本遍布全球。

GUANGDONG YAODA HOUSE TECHNOLOGY CO.,LTD is a professional manufacture of prefabricated house with more than 22 years experience. We are the top enterprise in the same field, the annual sale have reached 400 million.

We have rich experience in the designing, producing, installation and exporting during the 10 years. The prefabricated house is fireproof, waterproof, sound-insulating, heat-insulating, earthquake resistant, corrosion resistant, etc. It's large used in the field of temporary housing, warehouse, stadium, exhibition and other temporary buildings.

Depending on our good quality and excellent after selling service, our products are very popular in the regions inside and outside China. We have already successful cooperated with many customers all over the world. Our products have been sent to many countries such as Saudi Arabia, Dubai, Australia, Singapore, Sudan, Algeria, Qatar, Indonesia, etc.



R&D center-50000m²



M [生产设备] Machine introduction



耀达房屋科技集团拥有5万平方米的生产基地，具有多条自主研发的现代化自动设备生产线，年生产钢结构民用和工业用建筑30万m²，板材20万m²。现集团旗下拥有员工400多人，其中中高级技工100多人，专业的安装队100多人，年生产与安装活动房屋20万m²以上。产品销往国内多个省市及出口亚洲、非洲、南美洲、中东、大洋洲等100多个国家与地区，深受国内外的客户信赖！

The group has 50,000 square meters of production base, equipped with many self-developed modern automatic production lines. Its annual output for civil and industrial construction is 300,000 m², while for steel plates is around 200,000 m². At the meantime, the group owns approximately 400 employees, including more than 100 senior technicians and a professional installation team of over hundred people. The annual production and installation capacity reaches more than 200,000 m². And the products are sold to the domestic market into various provinces /cities and exported to more than 100 countries and regions in Asia, Africa, South America, Middle East as well as Oceania. Therefore, Yaoda has gained a very good reputation in domestic and oversea markets with high customer trust and satisfaction!



H型钢龙门式自动埋弧焊机
H type steel Longmen type welding machine



数显上辊万能式卷板机
Digital display on roller universal machine



数控钢板火焰切割机
CNC Cutting Machine

悉数铿锵征程，步步稳健为营

We are well-prepared for the future with our careful thinking and positive acting.

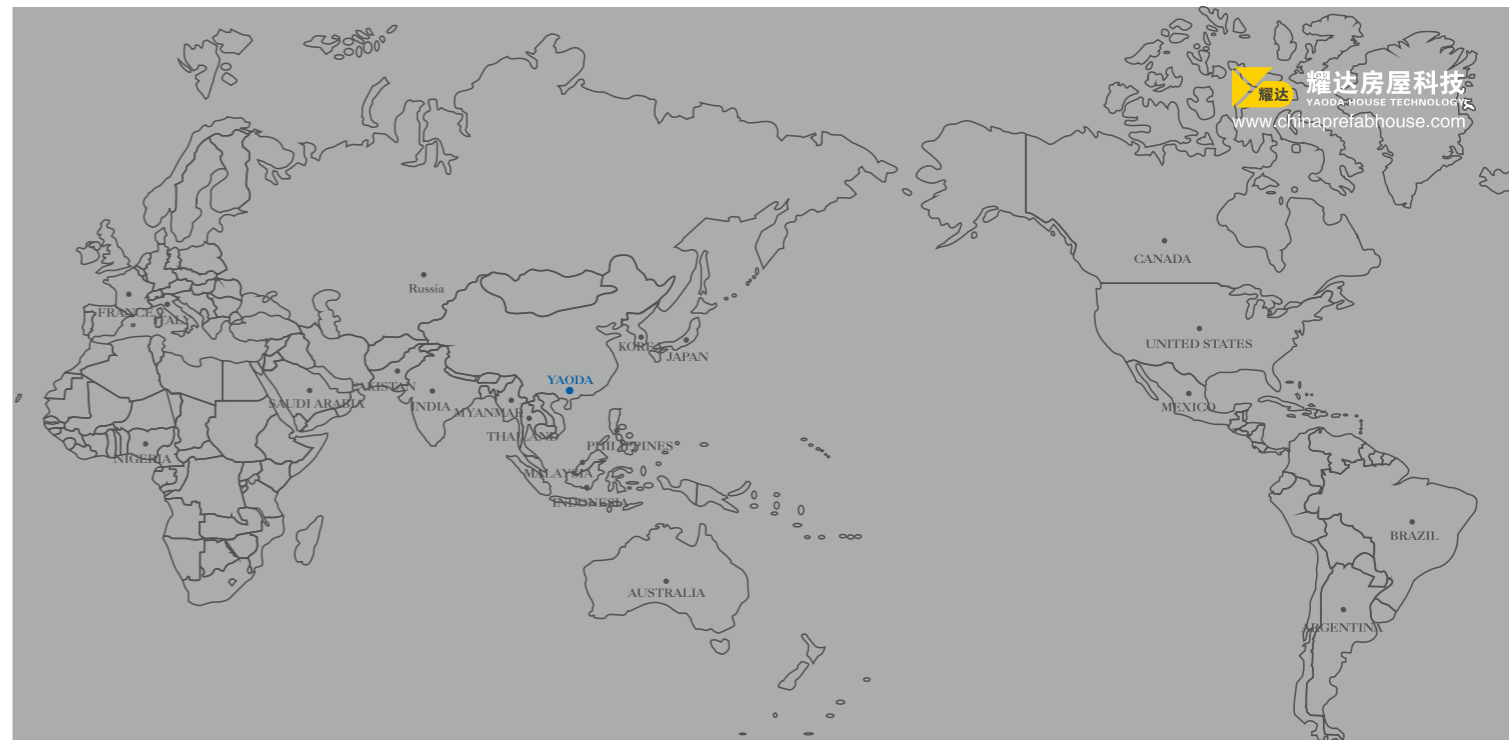

S [销售网络] Sales network

事实胜于雄辩，业绩印证发展
Facts speak louder than words; the performances have reflected our development

10多年的外贸历程，耀达本着“思利及人”的营销理念，卓越的产品品质和高效贴心的服务模式，耀达产品从本土到国际，取得行业瞩目的成就。销售网络遍布东南亚、中东、非洲、澳洲和美洲等地区。

The past 10 years was a wonderful journey. Depending on our ‘customers first and win-win’ marketing concept, excellent products, technology & service. And our advanced operation principle in prefabricated house. Yaoda products went across from the local to the world, and gained great achievements in the same field. Our sales network has been covered the South-east Asia, Middle East, Africa, Australia and America, etc.



T [团队实力] Team strength



长期多名工程师负责海外国家的安装指导
There are many engineers being in charge of installation guiding oversea.

超过10多年的海外安装指导经验
With rich practical experience more than 10 years.

客户满意度为 99.5%
Customer satisfaction is 99.5%



总裁亲临指导/CEO project instruction



沙特T屋工程/T house project in Saudi

C [公司荣誉] Company honor

联合国唯一活动房屋指定供应商
The only one prefabricated house supplier to United Nation

中国活动房屋标准主要起草人
Main drafter of China prefabricated house state standard

具备丰富的海外板房实操经验
Rich experience in oversea government projects



联合国注册供应商
The United Nations
register suppliers



中国环境标志产品认证
Chinese environment
mark product



欧洲CE权威认证
The European
CE certification
authority



国际ISO9001质量认证
The international
ISO9001 quality
certification



国家燃烧等级认证
State combustion



国家认证防火绿色环保建筑材料
National certification of fire
green environmental protection
building materials

CE认证
CE Certificate

BV认证
Bureau Veritas

中国建材行业最具影响力品牌
Most influential brand in China

ISO 9001认证
ISO 9001 Certificate

发明专利证书
Invention patent certificate



S [耀达K房] standard k house -Sandwich panel house

此产品适用于办公室、宿舍、仓库、饭堂等用途
K house is suitable for the office, accommodation, stock, canteen, etc.



3KX12KX3P Plan for accommodation 1

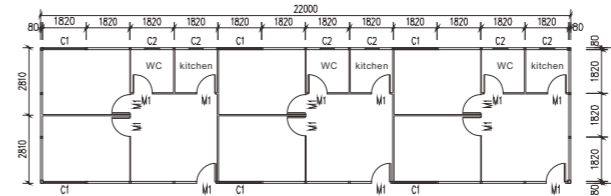

3KX12KX3P Plan for accommodation 2

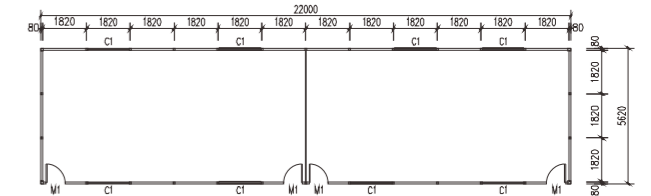

3KX12KX3P Plan for accommodation 3

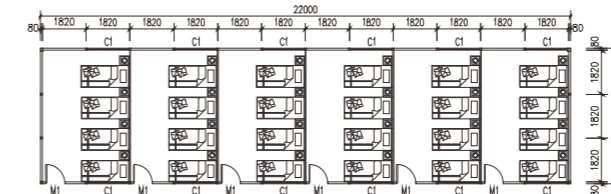

3KX12KX3P Plan for accommodation 4

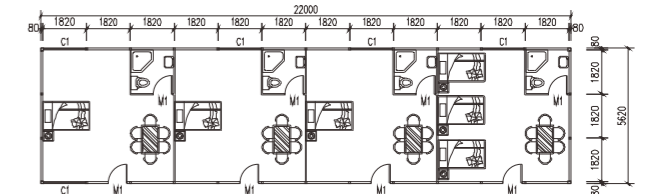

6KX12KX3P Plan for bathroom

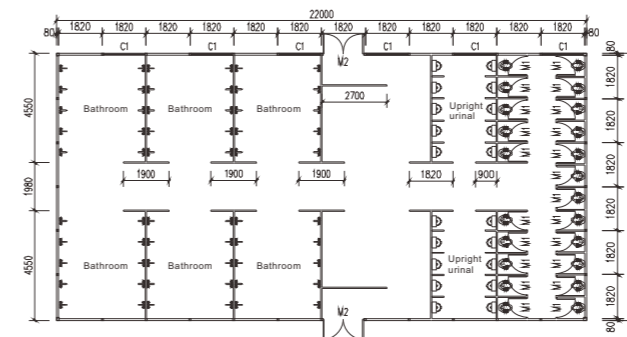

6KX12KX3P Plan for canteen

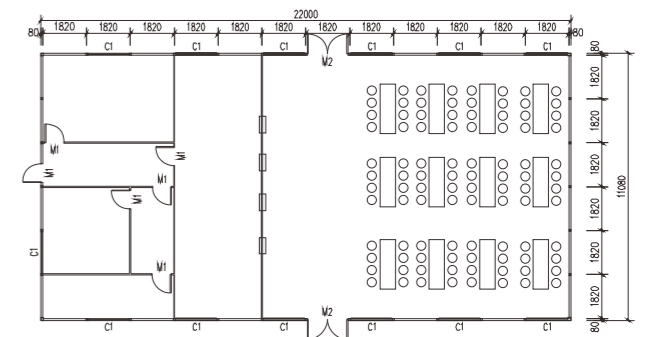

E [东帝汶K房] East Timor K house-Sandwich panel house

此产品适用于救灾房、贫民房、简易村落房等。
Suit for refugee house, poor people house, and cottage house, etc.

- ▶ Special structure for 7 grade earthquake resistance.
- ▶ 10 grade typhoon resistance design.
- ▶ Special design save 30% shipping freight.
- ▶ Cut down 100% installation cost.



INTRODUCTION:

- 1、EPS sandwich panel for roof and wall.
- 2、Galvanized steel structure for main frame.
- 3、Aluminium alloy sliding window and Sandwich panel door.

3KX4KX3P East timor K house

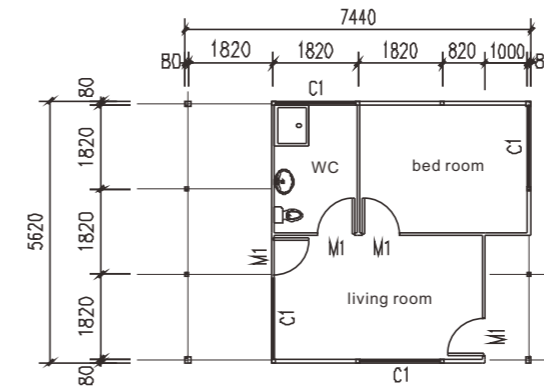

3KX4KX3P East timor K house



3KX5KX3P East timor K house

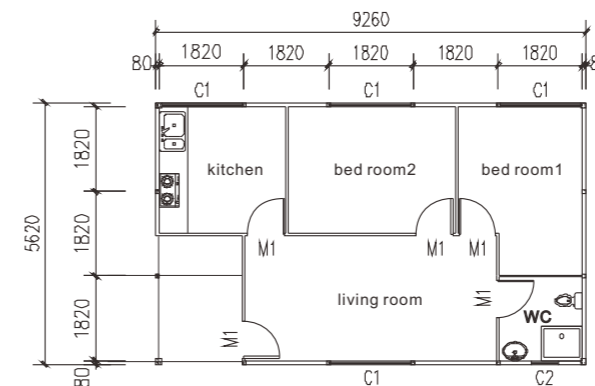

3KX5KX3P East timor K house



标准模数板房主体材料表

The material list comparing between the different style house

序号/ Number	部件名称/ Component name	坡顶型板房/ Slope style house			平顶型板房/ Flat style house
		普通型/ Normal classic	标准型/ Standard classic	高档型/ Luxury classic	豪华型/ Luxury classic
1	地梁/ Ground beam	8#C型钢/ 8#C section steel	8#C型钢/ 8#C section steel	8#C型钢/ 8#C section steel	55mm镀锌槽/ 55mm Z inc channel steel
2	立柱/Column	双8#C型钢/ Double 8# section steel	双8#C型钢/ Double 8# section steel	双8#C型钢/ Double 8# section steel	双14#C型钢/ Double 14# section steel
3	圈梁/ Ring beam	8#C型钢/ 8#C section steel	8#C型钢/ 8#C section steel	8#C型钢/ 8#C section steel	
4	一字梁/ “—”shape beam	16#C型钢/ 16# section steel	16#C型钢/ 16# section steel	16#C型钢/ 16# section steel	双18#C型钢/ Double 18# C section steel
5	楼面槽条/ Purlin in the floor	8#C型钢/ 8#C section steel	8#C型钢/ 8#C section steel	8#C型钢/ 8#C section steel	8#C型钢/ 8#C section steel
6	屋架梁/ “A”shape beam	8#C型钢/ 8#C section steel	8#C型钢/ 8#C section steel	8#C型钢/ 8#C section steel	
7	屋面槽条/ Purlin in the roof	L40角钢/ L40 angle iron	L40角钢/ L40 angle iron	L40角钢/ L40 angle iron	
8	楼梯/Stair	钢楼梯/Steel stair	钢楼梯/Steel stair	钢楼梯/Steel stair	钢楼梯/Steel stair
9	走道板/ Aisle board	3mm花纹钢板/ 3mm grain board	3mm花纹钢板/ 3mm grain board	3mm花纹钢板/ 3mm grain board	3mm花纹钢板/ 3mm grain board
10	外墙板/ Exteri wall panel	外: 50mm彩钢夹芯板/ 内: 镀锌板/ Outer:50mm sandwich panel Inner: Zinc board	50mm彩钢夹芯板/ 50mm sandwich panel	50mm彩钢夹芯板/ 50mm sandwich panel	50mm彩钢夹芯板/ 50mm sandwich panel
11	内隔墙板/ Interior wall panel	50mm镁磷夹芯板/ 50mm double color Phosphor magnesium filled board	50mm彩钢夹芯板/ 50mm sandwich panel	50mm彩钢夹芯板/ 50mm sandwich panel	50mm彩钢夹芯板/ 50mm sandwich panel
12	屋面板/ Roof panel	20mm PU发泡瓦/ 20mm PU foamed tile	20mm PU发泡瓦/ 20mm PU foamed tile	50mm彩钢夹芯大波瓦/ 50mm sandwich roof panel	75mm彩钢夹芯大波瓦/ 75mm sandwich roof panel
13	楼板/ Floor board	15mm木夹板/ 15mm ply wood board	15mm木夹板/ 15mm ply wood board	15mm木夹板/ 15mm ply wood board	15mm木夹板/ 15mm ply wood board
14	窗/ Window	塑钢推拉窗/ Plastic steel sliding window	塑钢推拉窗/ Plastic steel sliding window	塑钢推拉窗/ Plastic steel sliding window	塑钢推拉窗/ Plastic steel sliding window
15	门/ Door	钢型门框彩钢复合门板/ Steel frame with sandwich panel door	钢型门框彩钢复合门板/ Steel frame with sandwich panel door	钢型门框彩钢复合门板/ Steel frame with sandwich panel door	钢型门框彩钢复合门板/ Steel frame with sandwich panel door

坡顶板房常用模数面积对照表

The area comparing form of slope style house

长/Length	宽/Width	单层/One Floor (3P)			双层/Two Floor (6P)			三层/Three Floor (9P)		
		3K	4K	5K	3K	4K	5K	3K	4K	5K
4	K	45.53	59.07	72.61	103.79	130.87	157.95	176.04	216.66	257.28
5	K	56.67	73.52	90.38	126.97	160.68	194.39	211.27	261.83	312.39
6	K	67.81	87.98	108.14	150.16	190.49	230.82	246.51	307.01	367.50
7	K	78.95	102.43	125.90	173.35	220.30	267.26	281.74	352.18	422.61
8	K	90.09	116.88	143.67	196.53	250.11	303.69	316.98	397.35	477.72
9	K	101.22	131.33	161.43	219.72	279.93	340.13	352.21	442.52	532.83
10	K	112.36	145.78	179.19	242.91	309.74	376.57	387.45	487.70	587.94
11	K	123.50	160.23	196.96	266.09	339.55	413.00	422.68	532.87	643.05
12	K	134.64	174.68	214.72	289.28	369.36	449.44	457.92	578.04	698.16
13	K	145.78	189.13	232.48	312.47	399.17	485.88	493.16	623.21	753.27
14	K	156.92	203.58	250.25	335.65	428.98	522.31	528.39	668.38	808.38
15	K	168.06	218.03	268.01	358.84	458.79	558.75	563.63	713.56	863.49
16	K	179.19	232.48	285.77	382.03	488.61	595.19	598.86	758.73	918.60
17	K	190.33	246.93	303.54	405.21	518.42	631.62	634.10	803.90	973.71
18	K	201.47	261.38	321.30	428.40	548.23	668.06	669.33	849.07	1028.82
19	K	212.61	275.84	339.06	451.59	578.04	704.49	704.57	894.25	1083.93
20	K	223.75	290.29	356.83	474.77	607.85	740.93	739.80	939.42	1139.04
21	K	234.89	304.74	374.59	497.96	637.66	777.37	775.04	984.59	1194.15
22	K	246.02	319.19	392.35	521.15	667.48	813.80	810.27	1029.76	1249.26
23	K	257.16	333.64	410.12	544.33	697.29	850.24	845.51	1074.94	1304.37
24	K	268.30	348.09	427.88	567.52	727.10	886.68	880.74	1120.11	1359.48
25	K	279.44	362.54	445.64	590.71	756.91	923.11	815.98	1165.28	1414.58
26	K	290.58	376.99	463.40	613.90	786.72	959.55	951.21	1210.45	1469.69
27	K	301.72	391.44	481.17	637.08	816.53	995.99	986.45	1255.63	1524.80
28	K	312.85	405.89	498.93	660.27	846.35	1032.42	1021.68	1300.80	1579.91
29	K	323.99	420.34	516.69	683.46	876.16	1068.86	1056.92	1345.97	1635.02
30	K	335.13	434.79	534.46	706.64	905.97	1105.30	1092.15	1391.14	1690.13

标准配2部楼梯，左右山墙各一部，每部标准楼梯4.5m²/部，转角楼梯16m²/部，增减楼梯时，按此数增减即可。

面积计算规则：

- 1、板房面积=外墙边长 x 外墙宽长 x 层数
- 2、标准楼梯4.5m²/部，转角楼梯16m²/部
- 3、雨篷按水平投影面积的一半计算。
- 4、走道按投影面积计算
- 5、飘出墙外的飘蓬板200mm范围内不计算面积
- 6、总面积=(1)+(2)+(3)+(4)
- 7、除特别说明外，工程量计算方法均按上述计算公式进行调整结算款

说明：以上面积规则同时适用于平顶型。

Explanation:

The two floors house has two pcs stair in standard. Each side of gable wall has one. The stair's area is 4.5m²/pc. The three floor stair is 16m²/pc. The area will increase or reduce according to stair's quantity

The regular of area counting way:

1. The house area: Exterior wall length x exterior wall width x floor number
2. Standard stair: 4.5m²/pc, corner stair (special for three floor house): 16m²/pc
3. Awning area: house shadow area x 0.5
4. Aisle board area: house shadow area
5. Total area= (1)+(2)+(3)+(4)
6. Expect the no standard house, this regular is suitable for all the house
7. Above regular also is fit for the flat style house

H [耀达带底座活动板房] ouses with steel base

Meeting room 2KX6KX3P

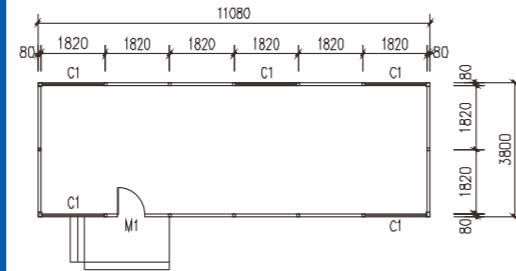

Sudan house 3Mx9Mx3H

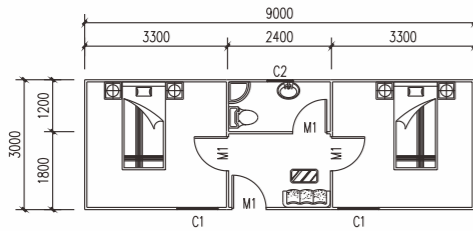

Singapore office



Y [耀达内藏立柱T房] aoda T house

Two floor dormitory



Two floor steel structure



Two floor Accommodation



M [材料应用] aterial application

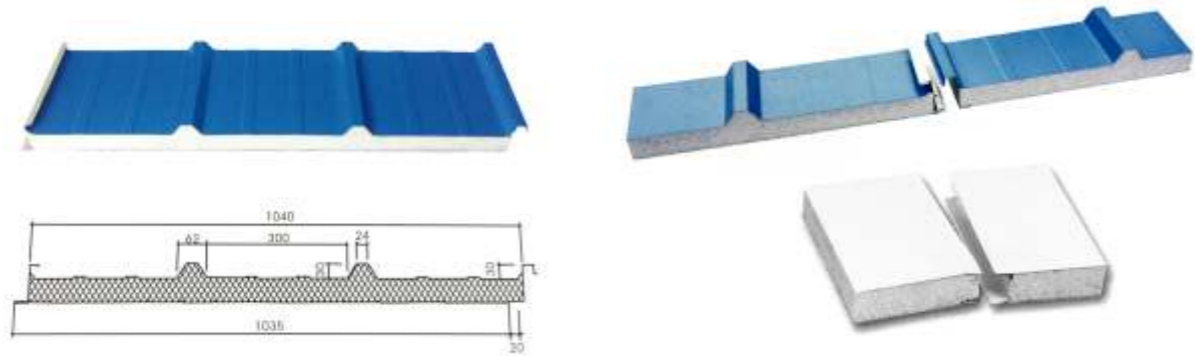

聚苯乙烯夹芯板 Polystyrene sandwich panel

聚苯乙烯夹芯板（泡沫夹芯板）是一种新型建筑板材，是由外层两侧钢板和内层聚苯乙烯经全电脑控制彩钢成型机加压加湿，并铺上高强度胶粘剂复合而成。

特点：自重轻，10-14kg/m³，安装方便，施工周期短，综合造价低，承载力高，整体刚度大，强度高。

使用灵活，板材长度可根据工程设计要求及安装运输条件确定。

隔热，隔音，保湿性能良好，平均导热系数：0.032千卡/米·时·度

Polystyrene sandwich panel is a new type of building material with EPS layer as the core, the color steel plates on both side externally. It is pressed by computer controlling color steel molding machine with high strength glue.

Feature: Light weight, 10-14kg/m³, convenient installation, short construction period, low building cost, high bearing capability, strong integrative stiffness and excellent strength.

Flexible usage, the length can be determined by requirements of project design as well as installation and transportation condition. It is of good heat and sound proofing as well as moisture-proofing, the average coefficient of heat conductivity is 0.032kcal/m.h.C



聚苯乙烯隔热板使用跨度选用表（控制变形小于L/240）单位：米
FORM of the spans of polystyrene sandwich panel house (Deformation controlled under L/240)

跨度/ Span (m)	板厚/ Thickness (mm)	50	75	100	150	200	250
25		5.19	6.91	8.09	9.91	11.45	12.80
50		3.74	4.96	5.72	7.01	8.09	9.05
100		2.53	3.49	4.05	4.96	5.72	6.40
150		1.90	2.70	3.31	4.05	4.57	5.23
200		1.40	2.10	2.80	3.51	4.05	4.53
250		1.10	1.70	2.30	3.13	3.62	4.05
300		0.90	1.40	1.90	2.86	3.31	3.70

PU发泡板 PU panel

PU发泡板是当今国际最新型的屋面板材，不但外表美观，材质轻型，安装方便，而且与同类产品相比具有极高的隔热性，隔音性，防火及使用寿命长等优点。安装采用直接搭接，施工便捷，造价相对较低，而且能更好地防止屋面脱胶，渗漏等现象，是钢结构厂房，工矿及民用建筑最理想的屋面材料。

PU发泡板上面采用彩色瓦楞（830）板，中间是20mm聚氨酯PU发泡的硬质塑料板，最下面的是花纹纸。在韩国、台湾，广东省及东南亚地区已经广泛使用，深受广大用户的欢迎。

PU foam panel is one of the popular roof material in the field. PU foam panel is not only beautiful in appearance, light in weight and convenient for installing, but also possesses the advantages of specially high heat-proofing and sound-proofing, and the long service life comparing with the other products in the same field.

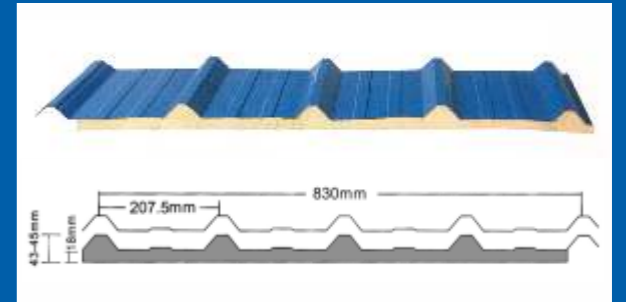

岩棉夹芯板 Rock wool sandwich panel

特点：岩棉夹芯板对噪声传达有显著的削减作用，特别适用对隔声有较高要求的地方。另外，采用岩棉屋面板后，雨水，冰雹对建筑物屋面板冲击面引起的室内声响，也明显减弱。通过测试，按照ISO717/82和UNI18270/7标准，选用密度为100kg/m³岩棉作芯材质的50-100mm厚夹芯板隔声效果可达到RW=29-30dB

岩棉芯材为非燃烧材料，故岩棉夹芯板具有超1000摄氏度的耐火能力。据意大利权威机构测定，岩棉夹芯面板和墙板面火极限为：

100mm厚(REI) 120分钟

75mm厚(REI) 60分钟

50mm厚(REI) 30分钟

50-75-100mm厚的岩棉板的耐火等级为0/1级（其耐火等级为高到低依次分为0、1、2、3、4、5级）



Feature

Rock wool sandwich panel has a good feature in noise reduction specially suitable for the place where is high requirements in the sound-insulation. Via testing according to ISO 717/82 and UNI18270/7 standards, selecting the rock wool which with the density 105kg/CBM and the thickness 50-100mm as the core, the sound coefficient will achieve RW=29-30dB.

Excellent fire resistance:

The ability of the fire-proofing of the rock wool sandwich panel is over 1000 for the rock wool is the non-fire material. According to the test of the Italy authority organization Istituto Giordano S.P.A, the fireproofing margin of rock wool sandwich panel is as below:(take the wall panel as the example)
Thickness: 100mm(REI) 120 minutes
75mm(REI) 60minutes
50mm(REI) 30minutes

The fireproof degree of rock wool panels of 50-75-100mm are 0/1 (with their fire-proof degrees from high to low is 0,1,2,3,4,5)



防冰雹
Anti hail



防水
Waterproof



防火
Fireproof

聚氨酯夹芯板 Polyurethane sandwich panel

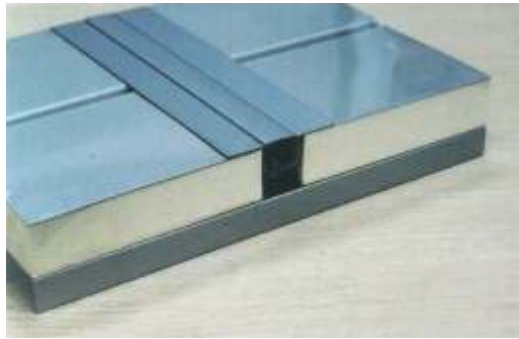

构造——上、下金属板表层，中间夹聚氨酯泡沫。金属表层可为彩色钢板、镀铝锌钢板、镀铝钢板及彩色压花钢板等。聚氨酯夹芯板为当今世界公认的隔热保温最佳材料。

特点——重量轻：10-14kg/m³

保温隔热性好：0.0175千卡/米.时.度，整体钢度好、承载力高
连接合理简便：屋面板采用扣接方式，避免了屋漏水的隐患，墙板采用公母口插接，外表美观，节省零配件用量，施工简便。

应用范围：工业厂房、仓库、大型公共场馆、别墅、组合式冷库等建筑物屋面及墙体。

Structure: Upper and lower metal exterior sheets sandwich with the PU foamed. The exterior metal sheet can be color steel sheet, aluminum&zinc coated steel sheet, aluminum coated steel sheet and embossed color steel sheet, etc. PU sandwich panel is the best heat resisting& maintaining material acknowledged in the world at present.

Feature: Light weight: 10-14kg/m³
Good heat resisting: 0.0175kcal/m.h.c. Strong integrative stiffness and excellent strength.

Reasonable and simple connection: For using the snap connection, the roof panel avoids the hidden trouble of roof leakage. The wall panel adopts coupling board connection. It takes the beautiful in appearance, economy of spare parts and convenient for construction.

Application range: Factory& work-shop, ware-house, public stadium and gymnasium, villa, cold storage and other buildings.

彩瓦金属压型板 Color corrugated steel sheet

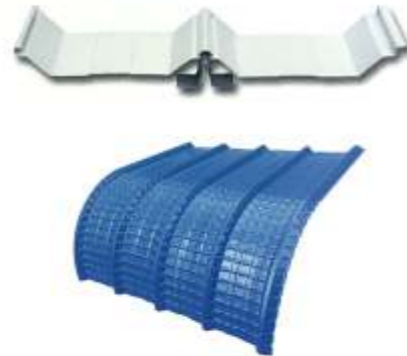
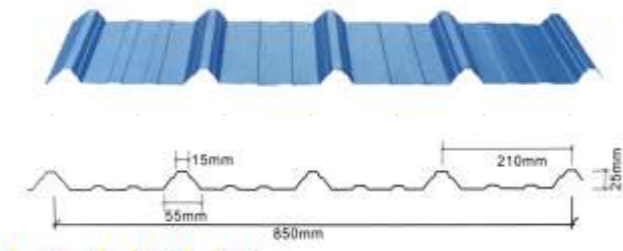

涡轮排气通风器 Turbo exhaust ventilator



钢承板 Steel deck

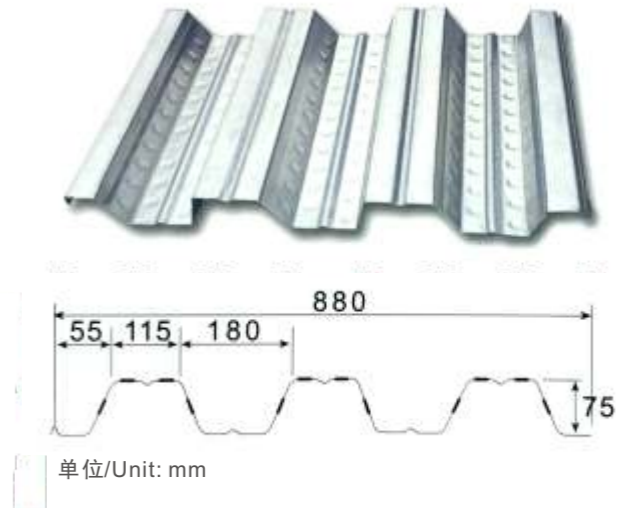

型 别/ Model	标准宽度/ Standard width(mm)	钢板总厚度/ Steel plates thickness(mm)	单位重量/ Unit weight (kg/ft)	单位面积重/ Weight/s. q. m		断面惯性力矩/ Inertia moment t(mm ⁴ /m)	断面系数/ Section coefficient s(mm ³ /m)
				kg-m ²	kg/坪pyeong		
YD3W75	880	0.80	2.54	9.54	31.55	1001181.38	26274.21
		1.00	3.03	11.37	37.58	1196382.77	31394.91
		1.20	3.61	13.55	44.77	1429643.04	37513.59

“C”&“Z”型钢檩条 “C”&“Z” Section steel

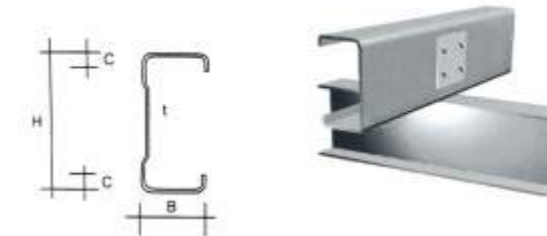

“Z”型钢解析图
“Z” Section steel view drawing

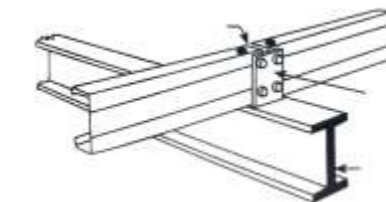

“C”型钢解析图
“C” Section steel view drawing



[耀达集装箱房] CONTAINER HOUSE

适合临时办公，住宿，士兵阵营。
Suit for temporary office, accommodation, soldier camp.

20'GP: 6.058MX2.438MX2.85H

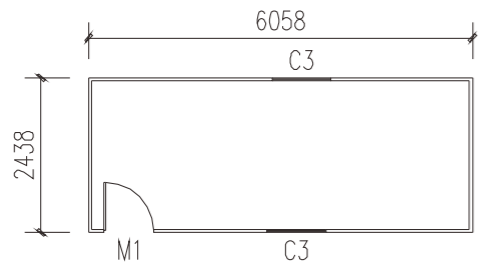

Container house inside picture



Container office



Qatar double floor container

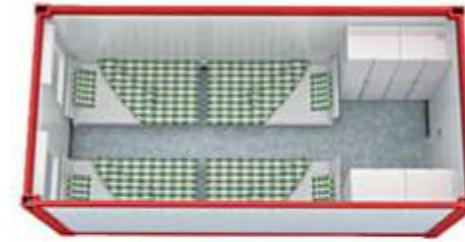

TYPE A



TYPE B



TYPE C



TYPE D



TYPE E

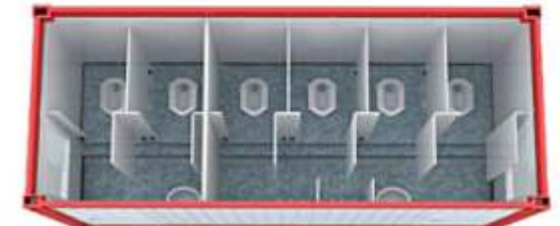

TYPE F

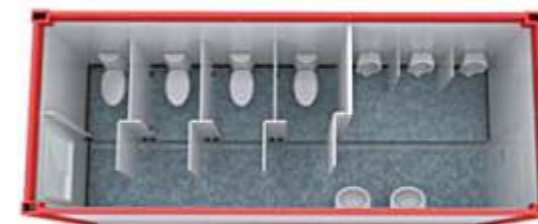

TYPE G



TYPE H

S [耀达钢结构] Steel structure

-workshop,warehouse, chicken sheds,Stadium seating,cool room
仓库, 厂房, 鸡棚, 体育馆座位, 冷库

A: EPS/Rock wool/PU sandwich panel for wall and roof.

B: 0.426mm/0.476mm Galvanized steel sheet for wall and roof.



A

B



A

Sandwich panel warehouse



Single steel sheet warehouse

B

S [耀达简单别墅] imple villa-Sandwich panel house

适用于高级办公室宿舍、家庭住房及灾区临时住宅。

Suit for supervisor dormitory, family house, poor people housing and disaster housing.

Simple villa – 100m², 3 bedrooms



HOT SALE

Simple villa – 100m², 3 bedrooms

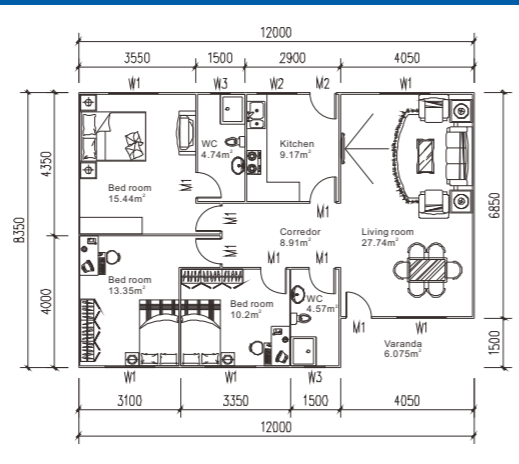

Simple villa – 94m², 2 bedrooms

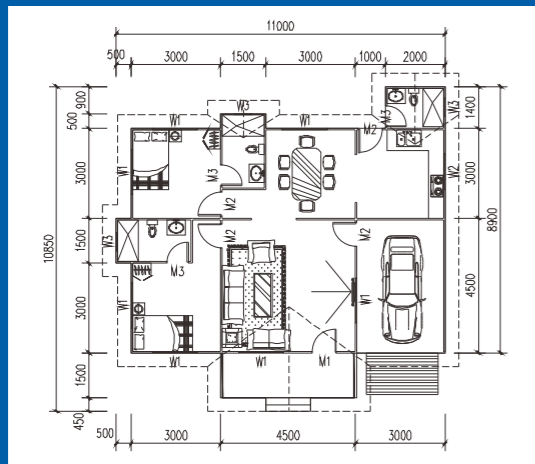

Simple villa – 94m², 2 bedrooms



HOT SALE

INTRODUCTION:

- 1、Steel structure for frame.
- 2、EPS/Rock wool/PU sandwich panel for wall and roof.
- 3、Alumnum alloy sliding window and steel door.

Simple villa – 60m², 2 bedrooms

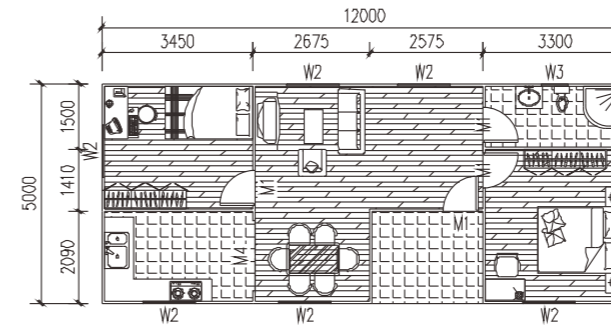

Simple villa – 60m², 2 bedrooms



Simple villa – 51.2m², 2 bedrooms



Simple villa – 51.2m², 2 bedrooms

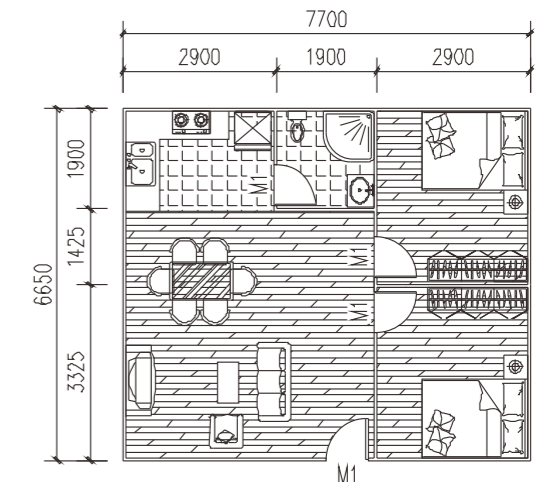

S [耀达春天别墅] Spring Villa-concrete Villa

使用寿命30年以上，适用于和旅游度假区、豪华度假屋、豪华办公室、豪华别墅。
Service life is more 30years, suit for cottage house, holiday resort, villa resort.

Indonesia villa 94m² -2 bedrooms

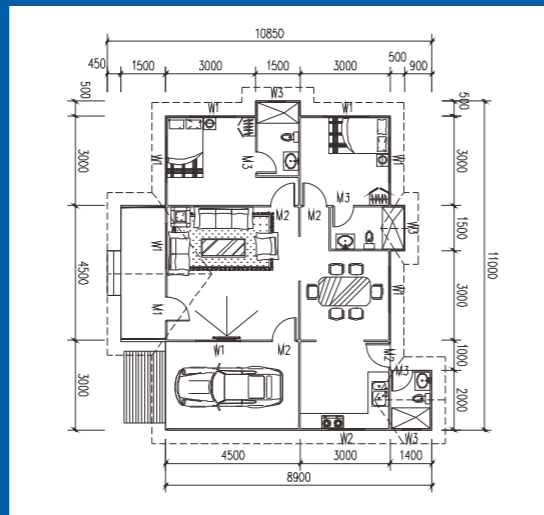

Australia villa 68m² , -2 bedrooms

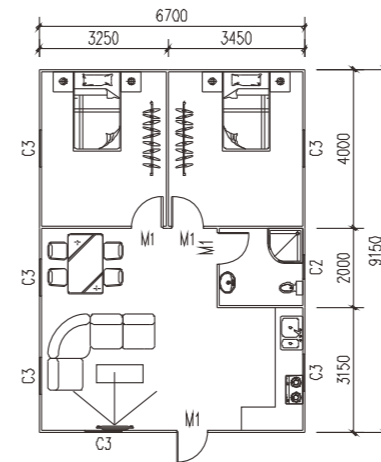

Australia villa 97.36m² , -3 bedrooms

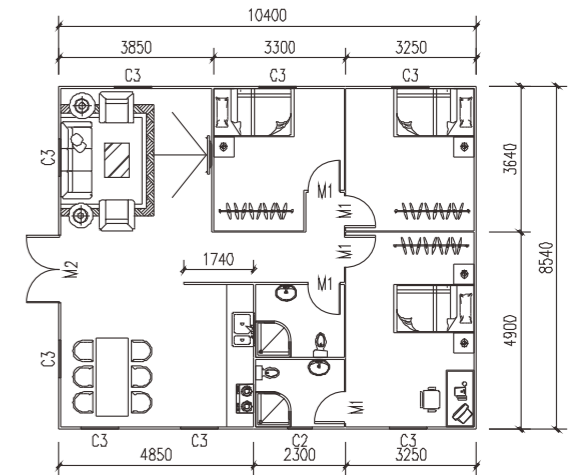

Australia villa 115.29m² , -3 bedrooms

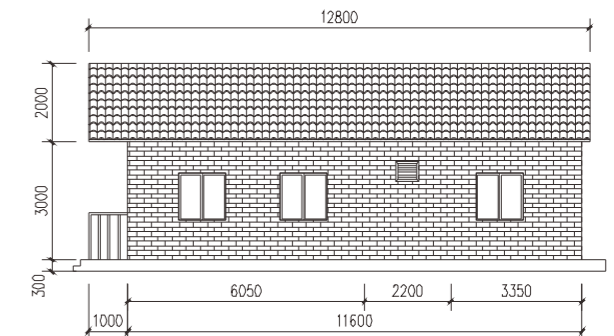
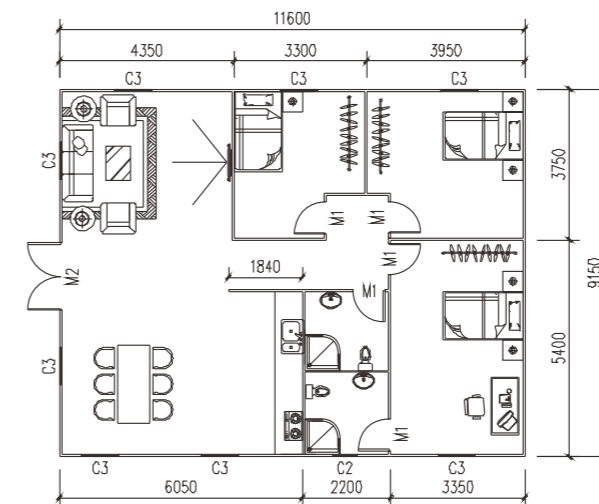

Australia Villa

HOT SALE



C [常用配件] Common accessories

门/Door



窗/Window



地板/Floor



C [常用配件] Common accessories

天花/Ceiling



厕所/Toilet



厕所/Toilet



E [工程实例] Engineering example

多年来，耀达产品以卓越的品质赢得无数赞誉，在市场上树立了良好的口碑，代表性工程项目遍布全球。未来，耀达房屋科技将一如既往地为您提供高品质、高技术的产品和项目。

Yaoda products gained much praise and established a good reputation by the high quality. The engineering cases had covered around the world. In the future, we will always offer you more and more high quality and technology products.



- ① 阿联酋营地项目/ UAE labour camp project
- ② 东帝汶办公室项目/ Timor leste office project
- ③ 泰国办公室项目/ Thailand office project
- ④ 老挝营地项目/Laos labour camp project
- ⑤ 泰国工人宿舍营地项目/Thailand worker dormitory project
- ⑥ 印尼宿舍项目工程/Indonesia worker dormitory project



Laos labour camp project



E [工程实例] Engineering example

Earthquake disaster housing project.

Suit for Disaster relief house and Temporary relocation settling house.



灾区全景图 / Panorama in the disaster area

四川赈灾项目 / Sichuan earthquake rebuild project





Laos worker camp project



Guilin K house project



Qatar K house project



Thailand K house project

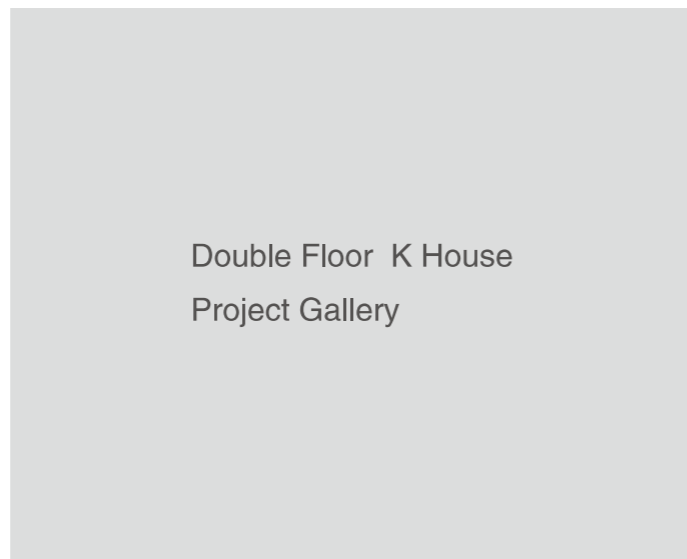

Double Floor K House
Project Gallery



Qatar K house project



Saudi K house project



Saudi K house project



Qatar K house project

E [工程实例] Engineering example



China workshop project



Indonesia warehouse project



China workshop project

1.Workshop
2.Warehouse
3.Chicken sheds



Mozambique warehouse project



Senegal Chicken sheds project

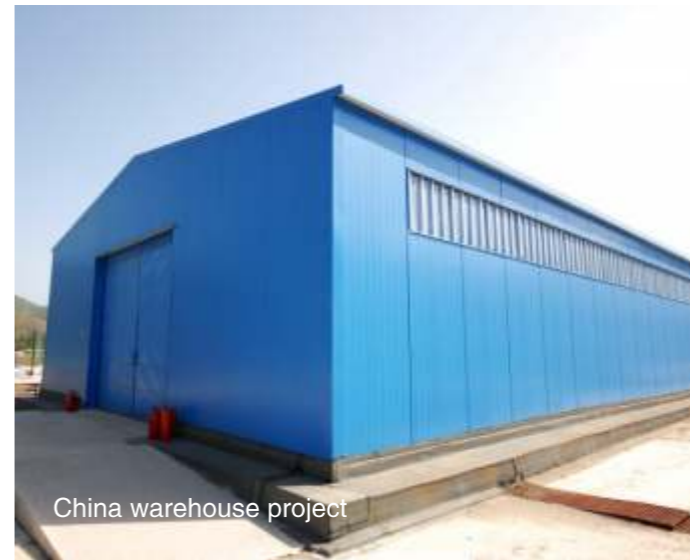

China warehouse project



China warehouse project

E [工程实例] Engineering example

Villa resort project



Summer villa



India spring villa project



India spring villa project



India spring villa project



India spring villa project



Brazil Australia villa



PNG double floor



PNG double floor villa

P [产品优势 -EAST TIMOR HOUSE] Product advantage

中国国家专利产品。

China state patent products.

更耐用，增加20%以上的使用年限。

Durable: the service life is 20% longer than normal k house.

最新设计更加节约装柜空间，运输成本节约30%。

The newest design saves much space and cost in freight.

整体美观更优化。

Beautiful overall appearance.

安装更加人性化。

Humanization installation.

可以安装太阳能系统，适合于无电区域。

The newest energy resources solar was applied in our system. This new technology enlarge our products to the region without the electric.



E [优秀团队] Excellent team

中国最早发展活动板房市场外贸团队之一，丰富的外贸经验，分工明确。

10年以上现场指导安装经验及管理，包括巴西、智利、非洲、东南亚、中东、澳洲等国家。

Our International Trading team is one of the earliest team in prefabricated house industry. With rich experience and clear division.

We possess of a strong team for installation. This team has many technicians over 10 years experience in the installation and building site management. Their footprint had been covered Brazil, Chile, Africa, South-East Asia, Middle East and Australia, etc.



实力拥抱未来

Strength embrace the future



多年的奋斗：耀达在活动房屋的开发设计方向进行积极探索，立志在绿色低碳和环境保护方面成为行业表率。

多年的奋斗：耀达专注于团队的不断优化，专业的团队更能理解用户的需求，打造更适用于用户的方案。

耀达坚持“诚信、专注、开拓、创新”为永恒发展之道，使命引领行业，实力缔造传奇。天高海阔，荣耀抵达。

Over 22 years strived, YAODA active explorations in house technology, set an example for low-carbon and environmental protection industry.

Over 22 years strived, YAODA is always in a position in improving the team management, a better team will be easy to catch the requirement of the client, and make a best proposal.

YAODA always consists “integrity, dedication, pioneering and innovative” as the truth in company developing. It always tells us to create legend with strength and lead the industry with mission.

耀达公司作为中国活动板房国家标准主要起草人之一，出席活动房行业参加国家专利展。

YAODA act as the one of main drafter of China prefabricated house state standard, Attended The State Patent Exhibition Represent The China Prefabricated House Industry.

